

Mawson

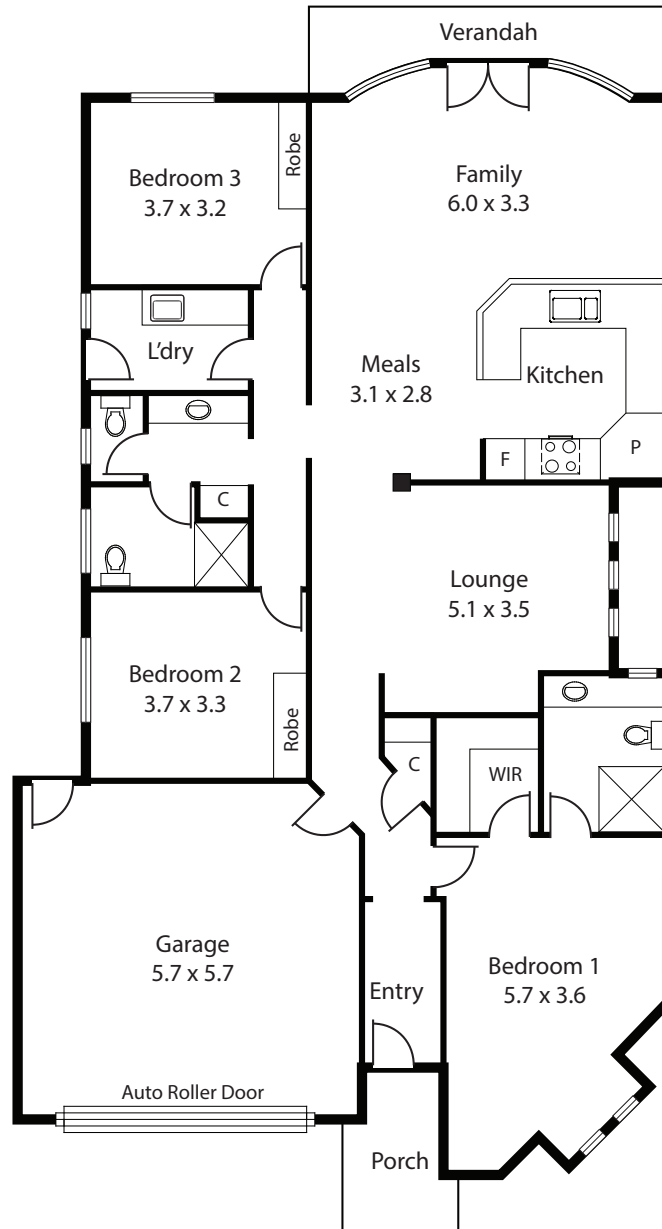

Features

- 9' Ceilings
- Decorative cornices & ceiling roses
- Insulated ceilings, external walls & bathroom
- IXL 'Tastic' light/heater
- Night light in passage
- Quality carpets & fittings
- Ducted reverse cycle air conditioning
- Linen press/storage cupboard
- Nyatah timber kitchen
- Dishwasher
- Family room
- Fully enclosed garage
- Automatic roller doors
- Security doors - front & sliding
- Door chimes
- Private fully enclosed backyard
- Manually operated sprinkler system
- 24 Hour call system with pendants
- Smoke alarm